

MODULINE



 *Pacific*  
Park Models

*“All The Comforts Of Home”*





**12040 Logan** 480 SQ. FT. (12' x 40')

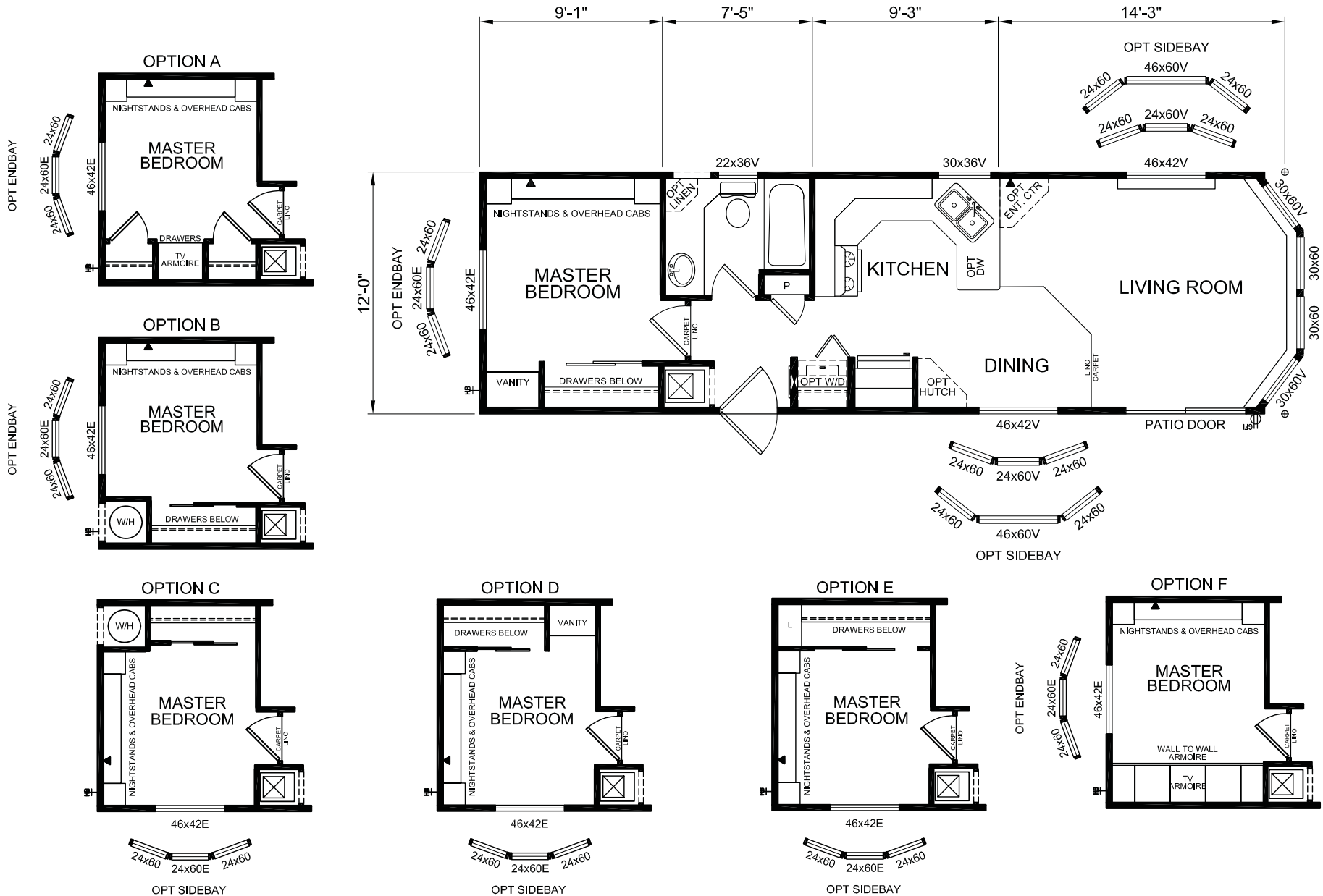

**12044 Meadow** 528 SQ. FT. (12' x 44')

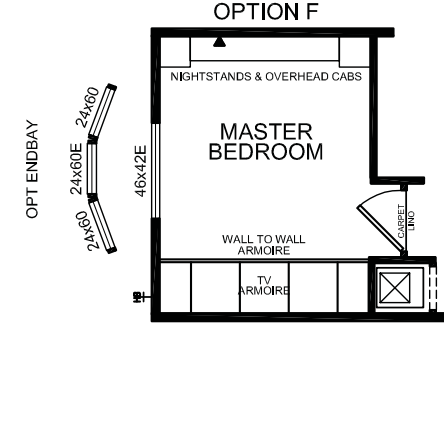
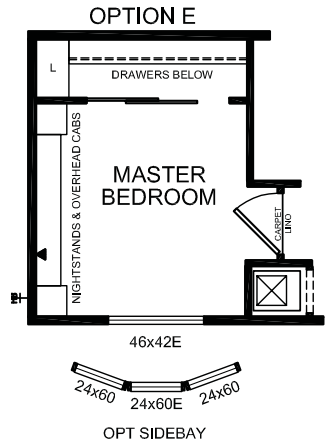
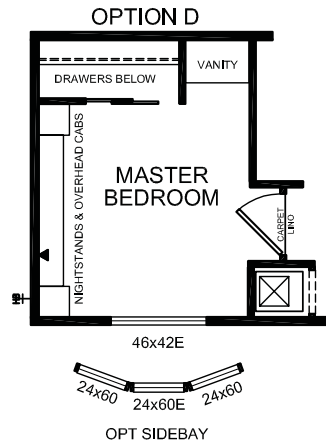
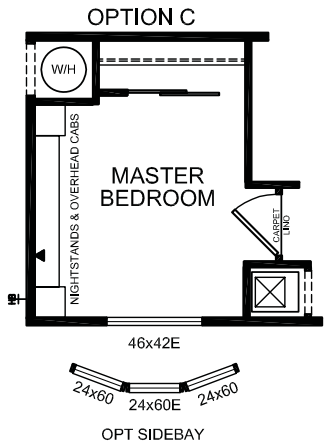
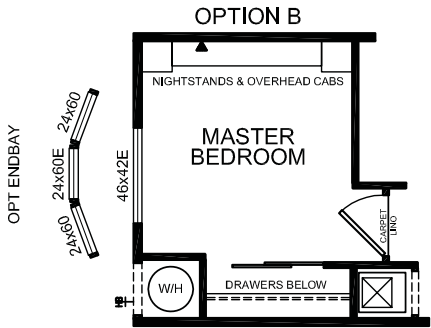
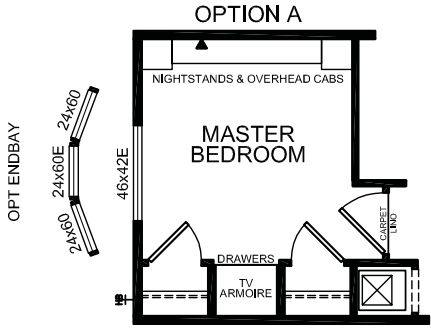
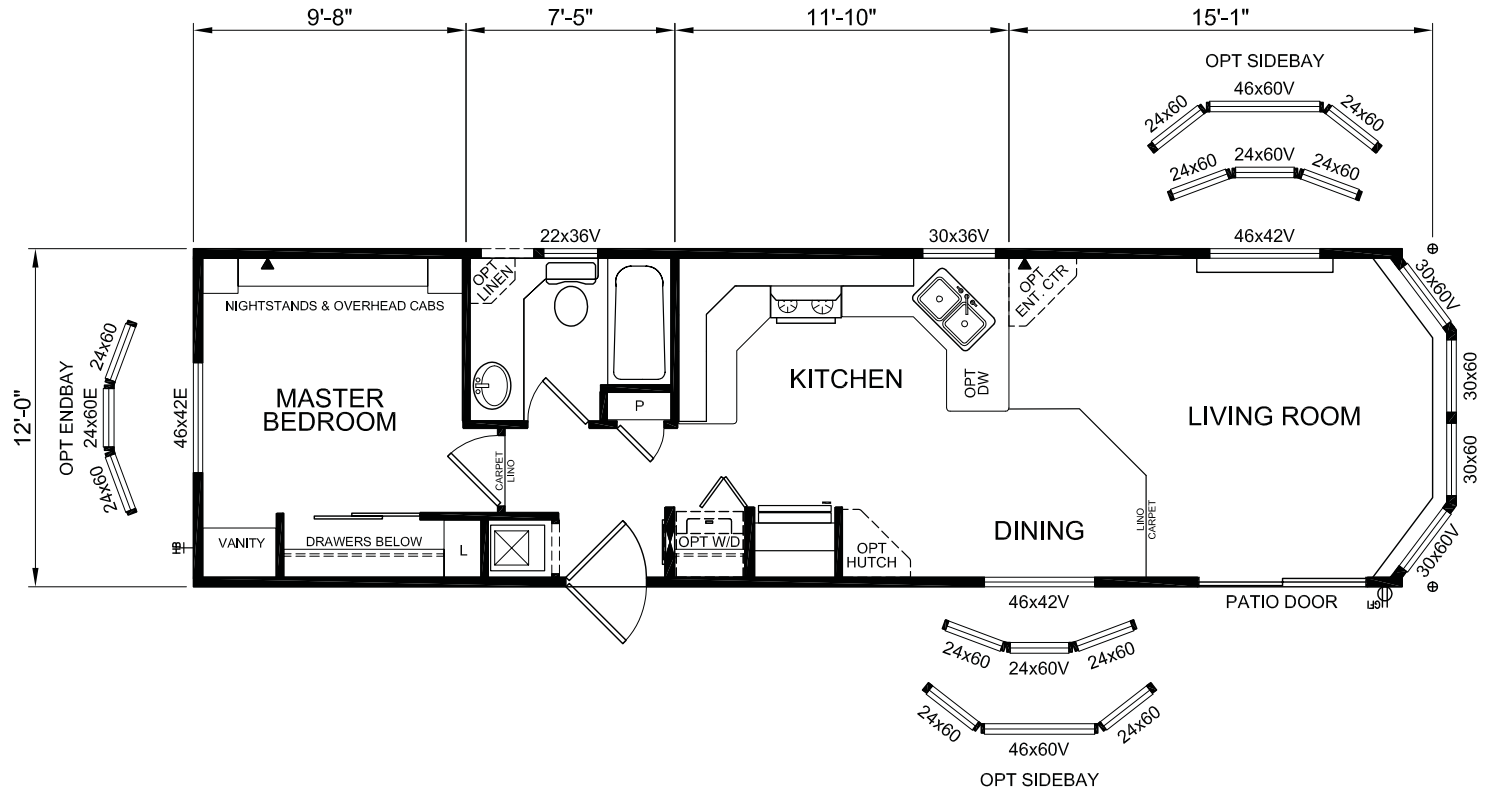





**12240 Watson** 480 SQ. FT. (12' x 40')

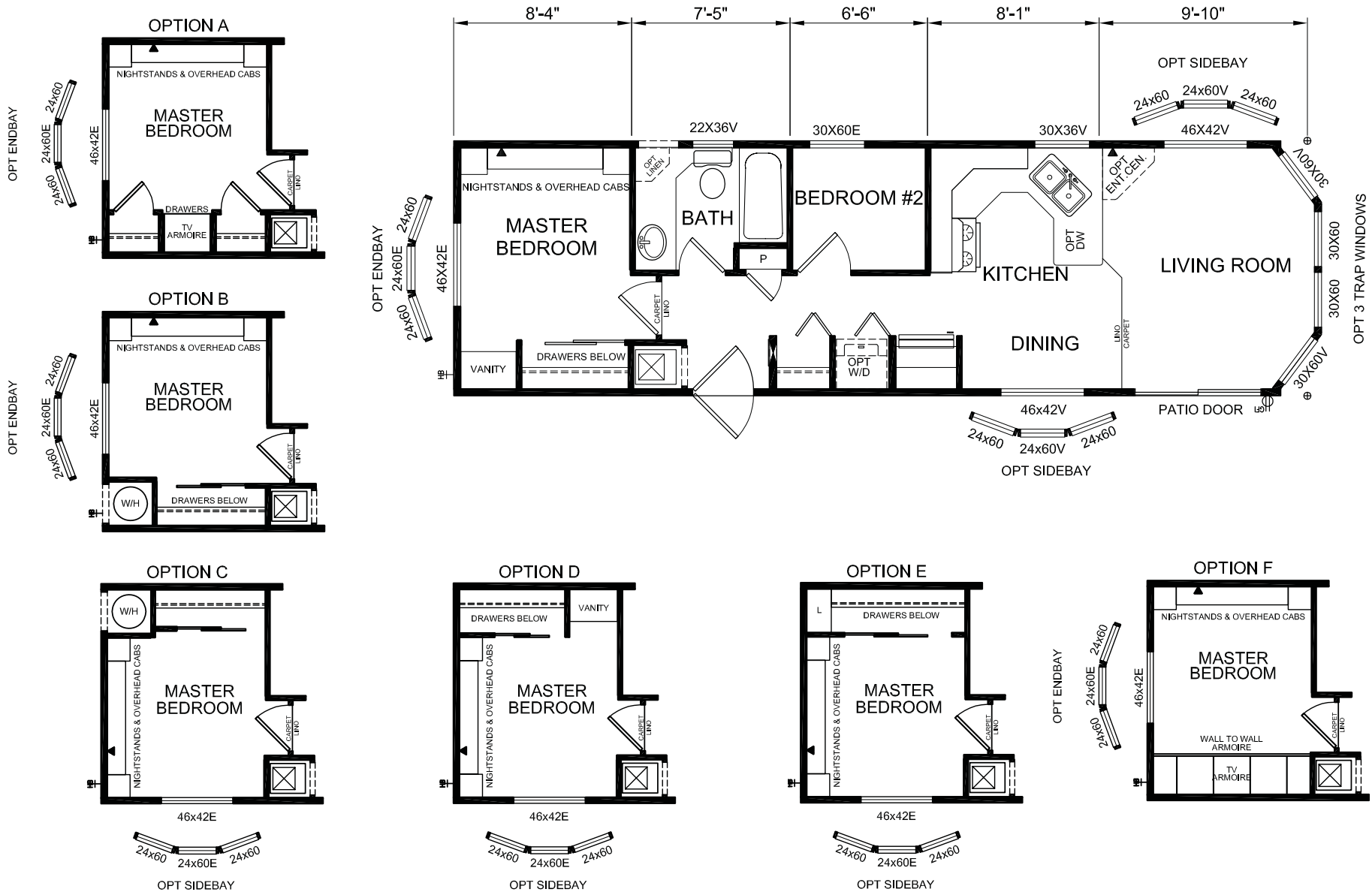

**12244 Livingstone** 528 SQ. FT. (12' x 44')

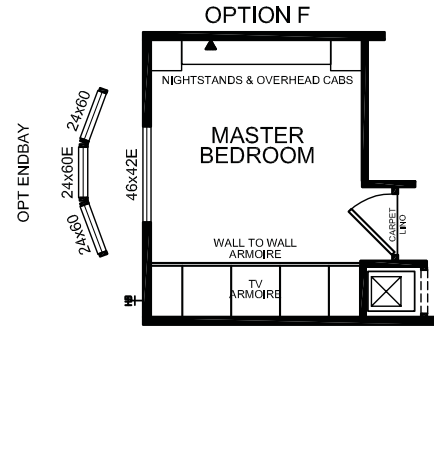
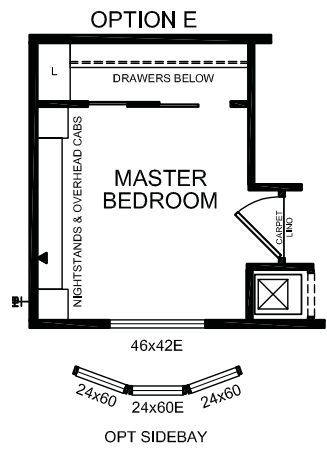
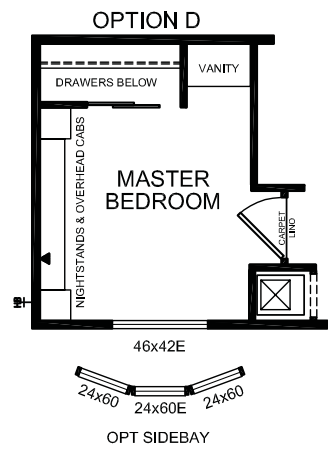
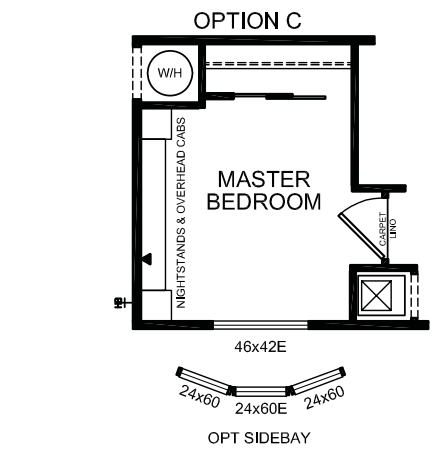
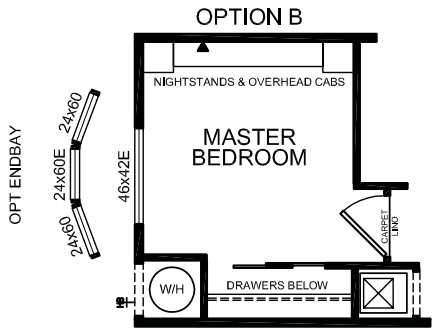
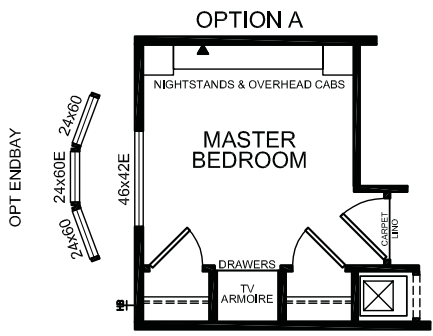
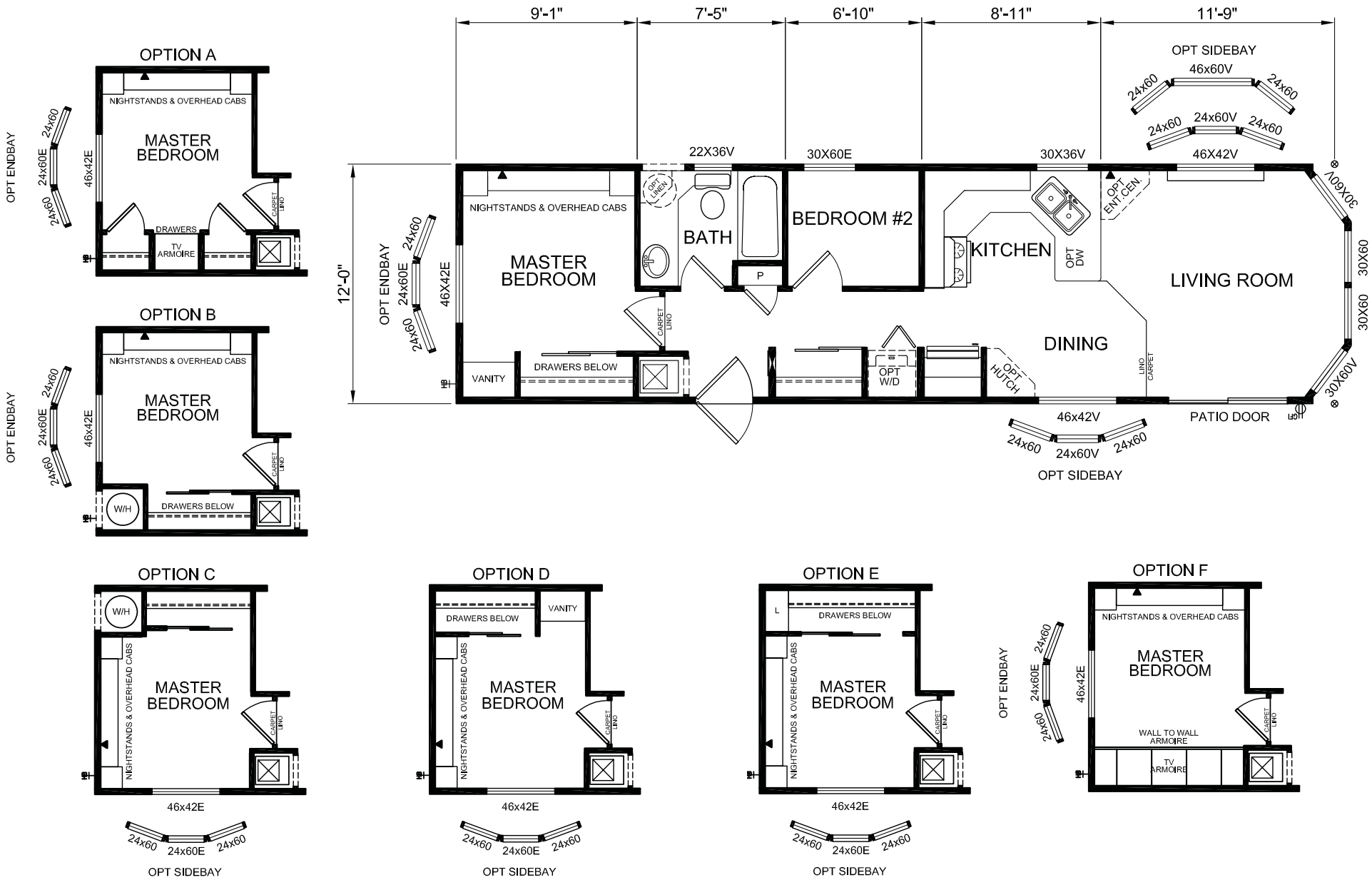



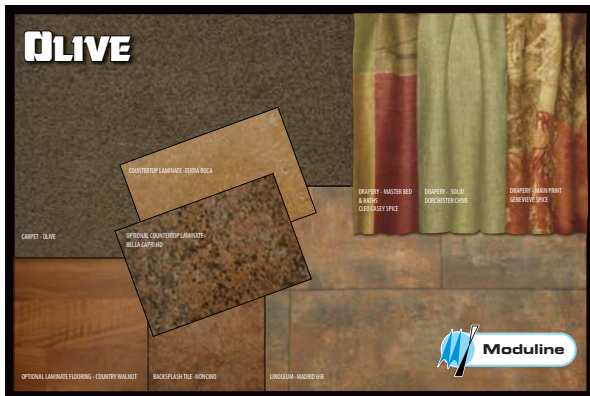

*Inspiring  
Decors...*

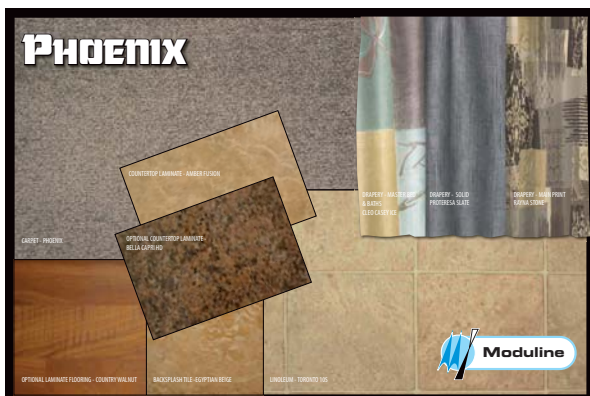



## STANDARD FEATURES & SPECIFICATIONS

### DISTINCTIVE FEATURES

- Built to the Z-241 code
- 8' Ceilings
- Front bay window (most models)
- Cathedral ceiling throughout
- Cathedral cove moulding throughout
- Décora switches and receptacles
- 7" Perimeter vented eaves
- Deluxe bedroom nightstands w/ cabinets
- Air conditioned ready (split system)

### GENERAL CONSTRUCTION

- 2" x 8" Floor Joist at 16" o.c.
- 2" x 4" sidewall, at 16" o.c.
- Detachable hitch
- Triple axles
- Heavy tubular steel frame
- 6 mil Interior vapour barrier
- Floor decking, 5/8" OSB T & G, glued & screwed
- 3/8" Exterior O.S.B. sheathing
- 7/16" Roof sheathing
- Fiberglass shingle roof (25 yr warranty)
- Engineered full 5.65/12 pitch roof trusses
- Maintenance free vinyl lap siding with metal fascia
- Residential Low E PVC vinyl windows
- Residential vinyl patio door with lock (most models)
- Coach lights at all exterior entrances
- Screen doors at rear exterior door
- Dehumidistat control
- Exterior GFI receptacle
- Exterior frost free tap
- Insulation – Roof R28, Floor R20, Wall R12
- Textured (primed) gyproc ceiling

### TASTEFUL INTERIORS

- Plush saxony carpet in Living Room and Master Bedroom
- Quality cushioned linoleum flooring in all other areas
- Coordinating window valance over venetian blinds in all areas except bathrooms and trap windows
- Shelf above LR windows

### BRIGHT, BEAUTIFUL KITCHENS

- Deluxe tile backsplash
- Pantry – select models
- 18 cu ft 2-Door frost free refrigerator
- 30" propane range
- Range hood with light
- Double stainless steel sink
- Dowelled full modular cabinetry w/crown moulding
- Three distinctive colors of cabinet doors to choose from

### SPACIOUS BATHS

- Obscure bath window w/decorative valance
- Deluxe tile backsplash
- One piece quality fiberglass tub and shower unit with single lever
- Power bath fan on separate switch
- Theatrical lights
- Residential type toilet and sink
- GFI receptacle

### UTILITY SERVICES

- Electronic ignition gas furnace
- 30 Gallon electric hot water tank
- 50 Amp electrical service with 25' cord
- Exterior propane line
- Heat tape plug
- CO2/Smoke detector(s) c/w battery backup
- Two communication outlets (LR & MBR)



All Moduline Homes offer a

**10**  
**YEAR WARRANTY**

